

In order to achieve the highest quality standards and ensure high safety and a long service life even under difficult operating conditions, all SPIR STAR ball valves are manufactured in trunnion style.

In this connection, we would like to emphasize that the valves can be offered with various orifice sizes. The valves are also provided with relief holes.

The marking on the valves allows them to be traced at any time.

In addition, the SPIR STAR ball valves are supplied including collar + gland nut.

Technical data:

Thread Types:	High Pressure, Medium Pressure and NPT
Valves Types:	2-Way Straight Valves, 3-Way Valves (90° diverting), 3-Way Valves (180° switching),
Material:	Body: 316 Stainless Steel Sealing: O-Ring with PEEK Backup Ring
Max. Working Pressure	1.380 bar // 20.000 psi
Temperature	-28°C to +204°C

Specials:

- extreme temperatures
- special materials
- electrical actuators

ATTENTION: We recommend not to use SPIR STAR ball valves with molecular gases (helium/hydrogen).

2-Way-Straight-Ball Valve



High-Pressure

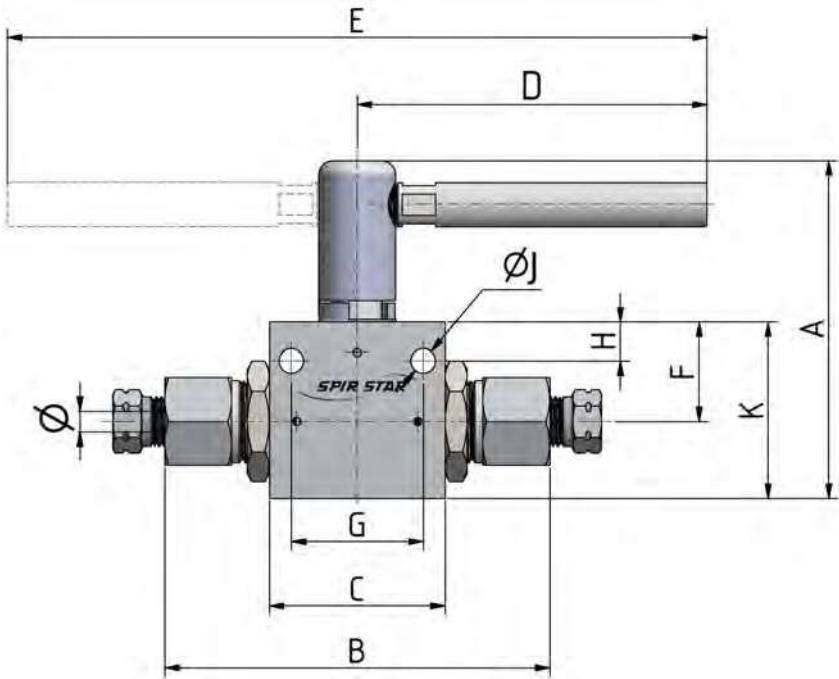

Part Number	Thread	Tube Thread	Screw-in Thread	Orifice		Repair Kit	Suitable Tubing
	Description			mm	inch		
Working pressure 1.380 bar / 20.000 psi							
SS-BVHF4-4-20K	HF4	1/4"x28UNF LH	9/16"x18UNF	6,350	0,250	RK-BV4T	TU-HP4-60K
SS-BVHF6-4-20K	HF6	3/8"x24UNF LH	3/4"-16UNF	6,350	0,250	RK-BV4T	TU-HP6-60K
SS-BVHF9-4-20K	HF9	9/16"x18UNF LH	1-1/8"x12UNF	6,350	0,250	RK-BV4T	TU-HP9-60K

Part Number	Unit	Dimensions												
		A	B	C	D1	D2	E	F	G	H	I	J	K	L
SS-BVHF4-4-20K	mm	97,30	110,50	50,80	101,10	-	-	28,70	38,10	11,20	-	7,10	50,80	-
	inch	3,83	4,35	2,00	3,98	-	-	1,13	1,50	0,44	-	0,28	2,00	-
SS-BVHF6-4-20K	mm	97,30	110,50	50,80	101,10	-	-	28,70	38,10	11,20	-	7,10	50,80	-
	inch	3,83	4,35	2,00	3,98	-	-	1,13	1,50	0,44	-	0,28	2,00	-
SS-BVHF9-4-20K	mm	97,30	110,50	50,80	101,10	-	-	28,70	38,10	11,20	-	7,10	50,80	-
	inch	3,83	4,35	2,00	3,98	-	-	1,13	1,50	0,44	-	0,28	2,00	-

2-Way-Straight-Ball Valve

Medium-Pressure

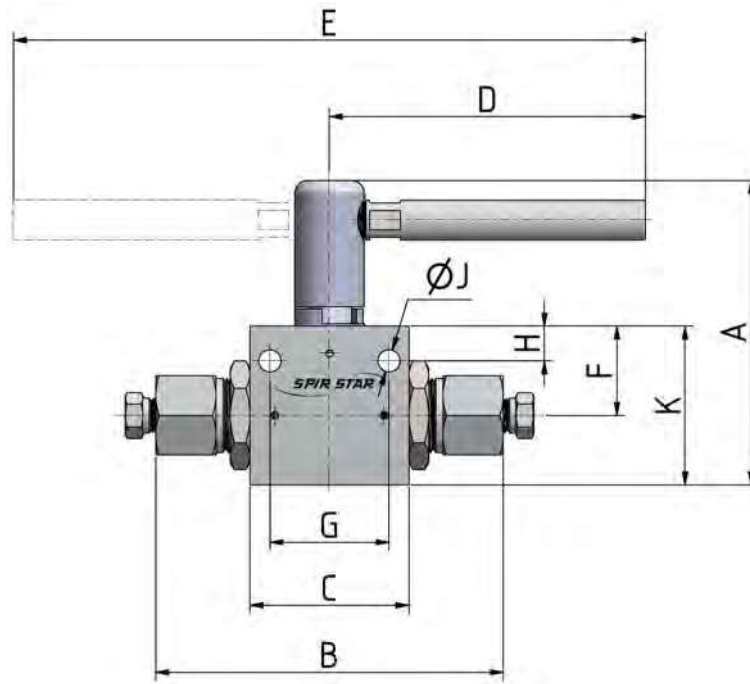

Part Number	Thread	Tube Thread	Screw-in Thread	Orifice		Repair Kit	Suitable Tubing
	Description			mm	inch		
Working pressure 1.035 bar / 15.000 psi							
SS-BVMF12-8-15K	MF12	3/4"x16UNF LH	3/4"x14NPSM	12,700	0,500	RK-BV8T	TU-MPI2-20K
SS-BVMF16-8-15K	MF16	1"x14UNF LH	1-3/8"x12UNF	12,700	0,500	RK-BV8T	TU-MPI6-20K
Working pressure 1.380 bar / 20.000 psi							
SS-BVMF4-4-20K	MF4	1/4"x28UNF LH	7/16"-20UNF	6,350	0,250	RK-BV4T	TU-MP4-20K
SS-BVMF4-6-20K	MF4	1/4"x28UNF LH	7/16"-20UNF	9,530	0,375	RK-BV6T	TU-MP4-20K
SS-BVMF6-4-20K	MF6	3/8"x24UNF LH	9/16"x18UNF	6,350	0,250	RK-BV4T	TU-MP6-20K
SS-BVMF6-6-20K	MF6	3/8"x24UNF LH	9/16"x18UNF	9,530	0,375	RK-BV6T	TU-MP6-20K
SS-BVMF9-4-20K	MF9	9/16"x18UNF LH	13/16"-16UNF	6,350	0,250	RK-BV4T	TU-MP9-20K
SS-BVMF9-6-20K	MF9	9/16"x18UNF LH	13/16"-16UNF	9,530	0,375	RK-BV6T	TU-MP9-20K
SS-BVMF12-6-20K	MF12	3/4"x16UNF LH	3/4"x14NPSM	9,530	0,375	RK-BV6T	TU-MPI2-20K

Part Number	Unit	Dimensions												
		A	B	C	D1	D2	E	F	G	H	I	J	K	L
SS-BVMF4-4-20K	mm	97,30	110,50	50,80	101,10	-	-	28,70	38,10	11,20	-	7,10	50,80	-
	inch	3,83	4,35	2,00	3,98	-	-	1,13	1,50	0,44	-	0,28	2,00	-
SS-BVMF4-6-20K	mm	110,20	140,70	76,20	102,10	-	-	35,10	50,80	10,40	-	7,10	63,50	-
	inch	4,34	5,54	3,00	4,02	-	-	1,38	2,00	0,41	-	0,28	2,50	-
SS-BVMF6-4-20K	mm	97,30	110,50	50,80	101,10	-	-	28,70	38,10	11,20	-	7,10	50,80	-
	inch	3,83	4,35	2,00	3,98	-	-	1,13	1,50	0,44	-	0,28	2,00	-
SS-BVMF6-6-20K	mm	110,20	140,70	76,20	102,10	-	-	35,10	50,80	10,40	-	7,10	63,50	-
	inch	4,34	5,54	3,00	4,02	-	-	1,38	2,00	0,41	-	0,28	2,50	-
SS-BVMF9-4-20K	mm	97,30	110,50	50,80	101,10	-	-	28,70	38,10	11,20	-	7,10	50,80	-
	inch	3,83	4,35	2,00	3,98	-	-	1,13	1,50	0,44	-	0,28	2,00	-
SS-BVMF9-6-20K	mm	110,20	140,70	76,20	102,10	-	-	35,10	50,80	10,40	-	7,10	63,50	-
	inch	4,34	5,54	3,00	4,02	-	-	1,38	2,00	0,41	-	0,28	2,50	-
SS-BVMF12-6-20K	mm	110,20	140,70	76,20	102,10	-	-	35,10	50,80	10,40	-	7,10	63,50	-
	inch	4,34	5,54	3,00	4,02	-	-	1,38	2,00	0,41	-	0,28	2,50	-
SS-BVMF12-8-15K	mm	141,50	195,30	104,90	130,30	-	260,60	44,70	76,20	12,70	-	7,10	78,50	-
	inch	5,57	7,69	4,13	5,13	-	10,26	1,76	3,00	0,50	-	0,28	3,09	-
SS-BVMF16-8-15K	mm	141,50	195,30	104,90	130,30	-	260,60	44,70	76,20	12,70	-	7,10	78,50	-
	inch	5,57	7,69	4,13	5,13	-	10,26	1,76	3,00	0,50	-	0,28	3,09	-

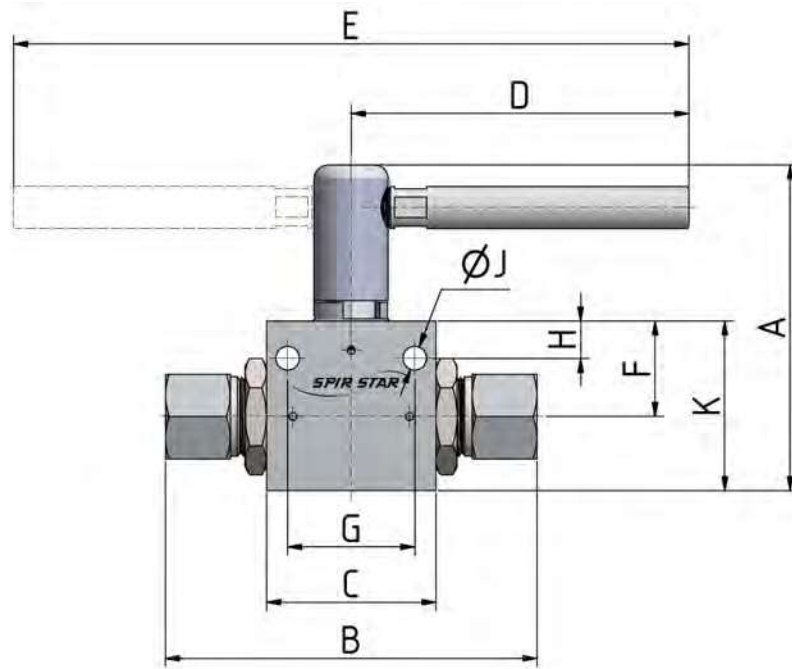

Part Number	Thread	Tube Thread	Screw-in Thread	Orifice		Repair Kit	Suitable Tubing
	Description			mm	inch		
Working pressure 690 bar / 10.000 psi							
SS-BVNF12-8-10K	NF12		3/4"	12,700	0,500	RK-BV8T	
SS-BVNF16-8-10K	NF16		1"	12,700	0,500	RK-BV8T	
Working pressure 1.035 bar / 15.000 psi							
SS-BVNF4-4-15K	NF4		1/4"	6,350	0,250	RK-BV4T	
SS-BVNF4-6-15K	NF4		1/4"	9,530	0,375	RK-BV6T	
SS-BVNF6-4-15K	NF6		3/8"	6,350	0,250	RK-BV4T	
SS-BVNF6-6-15K	NF6		3/8"	9,530	0,375	RK-BV6T	
SS-BVNF8-4-15K	NF8		1/2"	6,350	0,250	RK-BV4T	
SS-BVNF8-6-15K	NF8		1/2"	9,530	0,375	RK-BV6T	
SS-BVNF8-8-15K	NF8		1/2"	12,700	0,500	RK-BV8T	

Part Number	Unit	Dimensions												
		A	B	C	D1	D2	E	F	G	H	I	J	K	L
SS-BVNF4-4-15K	mm	97,30	110,50	50,80	101,10	-	-	28,70	38,10	11,20	-	7,10	50,80	-
	inch	3,83	4,35	2,00	3,98	-	-	1,13	1,50	0,44	-	0,28	2,00	-
SS-BVNF4-6-15K	mm	110,20	140,70	76,20	102,10	-	-	35,10	50,80	10,40	-	7,10	63,50	-
	inch	4,34	5,54	3,00	4,02	-	-	1,38	2,00	0,41	-	0,28	2,50	-
SS-BVNF6-4-15K	mm	97,30	110,50	50,80	101,10	-	-	28,70	38,10	11,20	-	7,10	50,80	-
	inch	3,83	4,35	2,00	3,98	-	-	1,13	1,50	0,44	-	0,28	2,00	-
SS-BVNF6-6-15K	mm	110,20	140,70	76,20	102,10	-	-	35,10	50,80	10,40	-	7,10	63,50	-
	inch	4,34	5,54	3,00	4,02	-	-	1,38	2,00	0,41	-	0,28	2,50	-
SS-BVNF8-4-15K	mm	97,30	110,50	50,80	101,10	-	-	28,70	38,10	11,20	-	7,10	50,80	-
	inch	3,83	4,35	2,00	3,98	-	-	1,13	1,50	0,44	-	0,28	2,00	-
SS-BVNF8-6-15K	mm	110,20	140,70	76,20	102,10	-	-	35,10	50,80	10,40	-	7,10	63,50	-
	inch	4,34	5,54	3,00	4,02	-	-	1,38	2,00	0,41	-	0,28	2,50	-
SS-BVNF8-8-15K	mm	141,50	195,30	104,90	130,30	-	260,60	44,70	76,20	12,70	-	7,10	78,50	-
	inch	5,57	7,69	4,13	5,13	-	10,26	1,76	3,00	0,50	-	0,28	3,09	-
SS-BVNF12-8-10K	mm	141,50	195,30	104,90	130,30	-	260,60	44,70	76,20	12,70	-	7,10	78,50	-
	inch	5,57	7,69	4,13	5,13	-	10,26	1,76	3,00	0,50	-	0,28	3,09	-
SS-BVNF16-8-10K	mm	141,50	195,30	104,90	130,30	-	260,60	44,70	76,20	12,70	-	7,10	78,50	-
	inch	5,57	7,69	4,13	5,13	-	10,26	1,76	3,00	0,50	-	0,28	3,09	-

3-Way-180° Switching-Ball Valve

High-Pressure

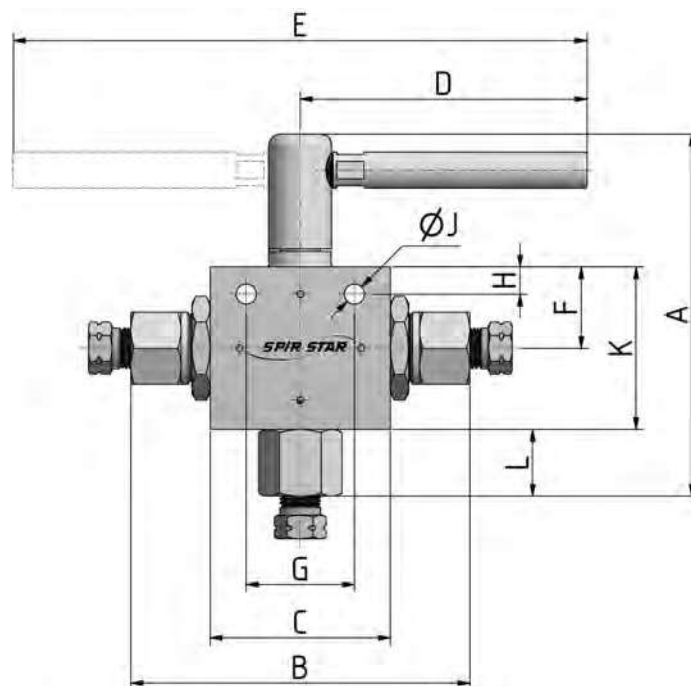

Part Number	Thread Description	Tube Thread	Screw-in Thread	Orifice		Repair Kit	Suitable Tubing
				mm	inch		
Working pressure 1.380 bar / 20.000 psi							
SS-BVHF4-3S-20K	HF4	1/4"x28UNF LH	9/16"x18UNF	4,780	0,188		TU-HP4-60K
SS-BVHF6-3S-20K	HF6	3/8"x24UNF LH	3/4"-16UNF	4,780	0,188		TU-HP6-60K
SS-BVHF9-3S-20K	HF9	9/16"x18UNF LH	1-1/8"x12UNF	4,780	0,188		TU-HP9-60K

Part Number	Unit	Dimensions												
		A	B	C	D1	D2	E	F	G	H	I	J	K	L
SS-BVHF4-3S-20K	mm	146,80	147,30	76,20	102,10	-	-	35,10	50,80	10,40	-	7,10	73,20	26,90
	inch	5,78	5,80	3,00	4,02	-	-	1,38	2,00	0,41	-	0,28	2,88	1,06
SS-BVHF6-3S-20K	mm	146,80	147,30	76,20	102,10	-	-	35,10	50,80	10,40	-	7,10	73,20	26,90
	inch	5,78	5,80	3,00	4,02	-	-	1,38	2,00	0,41	-	0,28	2,88	1,06
SS-BVHF9-3S-20K	mm	146,80	147,30	76,20	102,10	-	-	35,10	50,80	10,40	-	7,10	73,20	26,90
	inch	5,78	5,80	3,00	4,02	-	-	1,38	2,00	0,41	-	0,28	2,88	1,06

3-Way-180° Switching-Ball Valve

Medium-Pressure

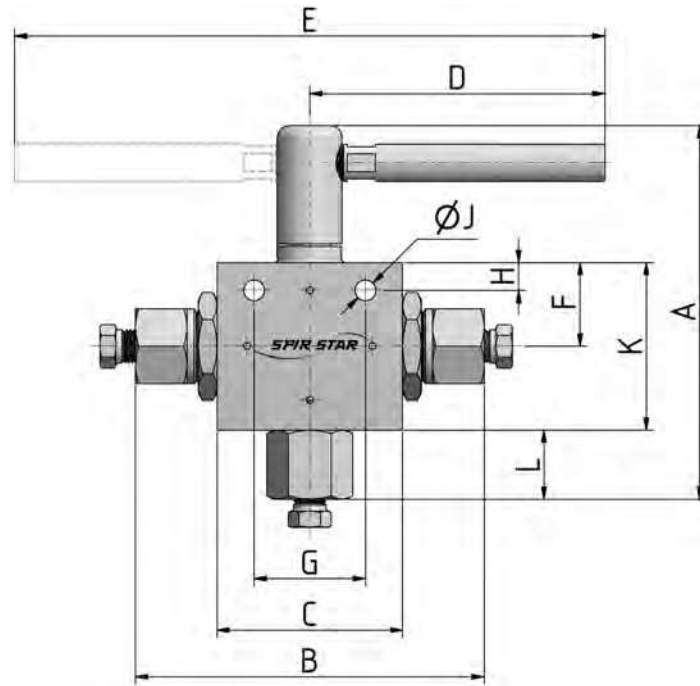

Part Number	Thread	Tube Thread	Screw-in Thread	Orifice		Repair Kit	Suitable Tubing
	Description			mm	inch		
Working pressure 690 bar / 10.000 psi							
SS-BVMF12-8S-10K	MF12	3/4"x16UNF LH	3/4"x14NPSM	12,700	0,500		TU-MPI2-20K
SS-BVMF16-8S-10K	MF16	1"x14UNF LH	1-3/8"x12UNF	12,700	0,500		TU-MPI6-20K
Working pressure 1.035 bar / 15.000 psi							
SS-BVMF6-6S-15K	MF6	3/8"x24UNF LH	9/16"x18UNF	9,530	0,375		TU-MP6-20K
SS-BVMF9-6S-15K	MF9	9/16"x18UNF LH	13/16"-16UNF	9,530	0,375		TU-MP9-20K
SS-BVMF12-6S-15K	MF12	3/4"x16UNF LH	3/4"x14NPSM	9,530	0,375		TU-MPI2-20K
Working pressure 1.380 bar / 20.000 psi							
SS-BVMF4-3S-20K	MF4	1/4"x28UNF LH	7/16"-20UNF	4,780	0,188		TU-MP4-20K
SS-BVMF6-3S-20K	MF6	3/8"x24UNF LH	9/16"x18UNF	4,780	0,188		TU-MP6-20K
SS-BVMF9-3S-20K	MF9	9/16"x18UNF LH	13/16"-16UNF	4,780	0,188		TU-MP9-20K

Part Number	Unit	Dimensions												
		A	B	C	D1	D2	E	F	G	H	I	J	K	L
SS-BVMF4-3S-20K	mm	146,80	147,30	76,20	102,10	-	-	35,10	50,80	10,40	-	7,10	73,20	26,90
	inch	5,78	5,80	3,00	4,02	-	-	1,38	2,00	0,41	-	0,28	2,88	1,06
SS-BVMF6-3S-20K	mm	146,80	147,30	76,20	102,10	-	-	35,10	50,80	10,40	-	7,10	73,20	26,90
	inch	5,78	5,80	3,00	4,02	-	-	1,38	2,00	0,41	-	0,28	2,88	1,06
SS-BVMF6-6S-15K	mm	146,80	147,30	76,20	102,10	-	-	35,10	50,80	10,40	7,10	-	73,20	26,90
	inch	5,78	5,80	3,00	4,02	-	-	1,38	2,00	0,41	0,28	-	2,88	1,06
SS-BVMF9-3S-20K	mm	146,80	147,30	76,20	102,10	-	-	35,10	50,80	10,40	-	7,10	73,20	26,90
	inch	5,78	5,80	3,00	4,02	-	-	1,38	2,00	0,41	-	0,28	2,88	1,06
SS-BVMF9-6S-15K	mm	146,80	147,30	76,20	102,10	-	-	35,10	50,80	10,40	7,10	-	73,20	26,90
	inch	5,78	5,80	3,00	4,02	-	-	1,38	2,00	0,41	0,28	-	2,88	1,06
SS-BVMF12-6S-15K	mm	146,80	147,30	76,20	102,10	-	-	35,10	50,80	10,40	7,10	-	73,20	26,90
	inch	5,78	5,80	3,00	4,02	-	-	1,38	2,00	0,41	0,28	-	2,88	1,06
SS-BVMF12-8S-10K	mm	198,90	197,40	104,90	130,00	-	260,35	-	42,20	76,20	12,70	7,10	84,80	43,20
	inch	7,83	7,77	4,13	5,12	-	10,25	-	1,66	3,00	0,50	0,28	3,34	1,70
SS-BVMF16-8S-10K	mm	198,90	197,40	104,90	130,00	-	260,35	-	42,20	76,20	12,70	7,10	84,80	43,20
	inch	7,83	7,77	4,13	5,12	-	10,25	-	1,66	3,00	0,50	0,28	3,34	1,70

3-Way-180° Switching-Ball Valve



NPT

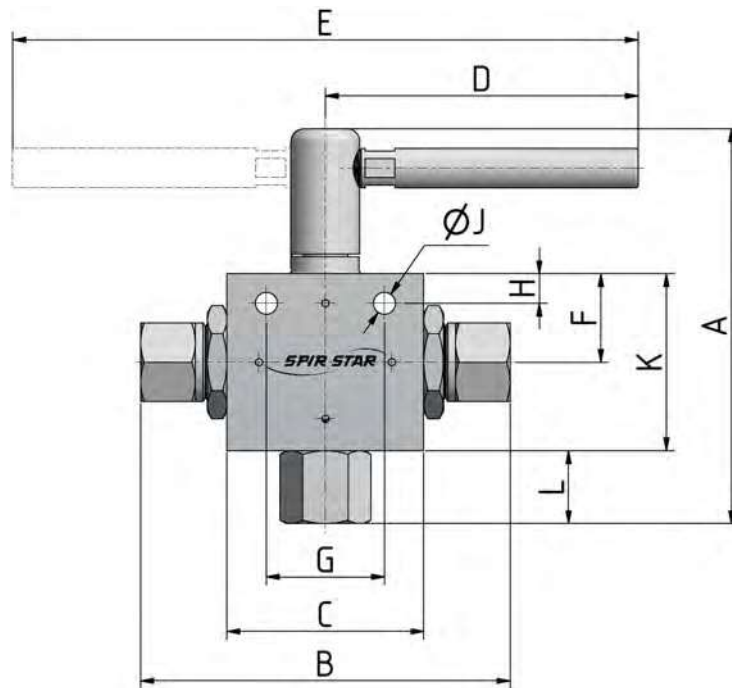

Part Number	Thread	Tube Thread	Screw-in Thread	Orifice		Repair Kit	Suitable Tubing
	Description			mm	inch		
Working pressure 690 bar / 10.000 psi							
SS-BVNF8-8S-10K	NF8		1/2"	12,700	0,500		
SS-BVNF12-8S-10K	NF12		3/4"	12,700	0,500		
SS-BVNF16-8S-10K	NF16		1"	12,700	0,500		
Working pressure 1.035 bar / 15.000 psi							
SS-BVNF4-3S-15K	NF4		1/4"	4,780	0,188		
SS-BVNF4-6S-15K	NF4		1/4"	9,530	0,375		
SS-BVNF6-3S-15K	NF6		3/8"	4,780	0,188		
SS-BVNF6-6S-15K	NF6		3/8"	9,530	0,375		
SS-BVNF8-3S-15K	NF8		1/2"	4,780	0,188		
SS-BVNF8-6S-15K	NF8		1/2"	9,530	0,375		

Part Number	Unit	Dimensions												
		A	B	C	D1	D2	E	F	G	H	I	J	K	L
SS-BVNF4-3S-15K	mm	146,80	147,30	76,20	102,10	-	-	35,10	50,80	10,40	-	7,10	73,20	26,90
	inch	5,78	5,80	3,00	4,02	-	-	1,38	2,00	0,41	-	0,28	2,88	1,06
SS-BVNF4-6S-15K	mm	146,80	147,30	76,20	102,10	-	-	35,10	50,80	10,40	7,10	-	73,20	26,90
	inch	5,78	5,80	3,00	4,02	-	-	1,38	2,00	0,41	0,28	-	2,88	1,06
SS-BVNF6-3S-15K	mm	146,80	147,30	76,20	102,10	-	-	35,10	50,80	10,40	-	7,10	73,20	26,90
	inch	5,78	5,80	3,00	4,02	-	-	1,38	2,00	0,41	-	0,28	2,88	1,06
SS-BVNF6-6S-15K	mm	146,80	147,30	76,20	102,10	-	-	35,10	50,80	10,40	7,10	-	73,20	26,90
	inch	5,78	5,80	3,00	4,02	-	-	1,38	2,00	0,41	0,28	-	2,88	1,06
SS-BVNF8-3S-15K	mm	146,80	147,30	76,20	102,10	-	-	35,10	50,80	10,40	-	7,10	73,20	26,90
	inch	5,78	5,80	3,00	4,02	-	-	1,38	2,00	0,41	-	0,28	2,88	1,06
SS-BVNF8-6S-15K	mm	146,80	147,30	76,20	102,10	-	-	35,10	50,80	10,40	7,10	-	73,20	26,90
	inch	5,78	5,80	3,00	4,02	-	-	1,38	2,00	0,41	0,28	-	2,88	1,06
SS-BVNF8-8S-10K	mm	198,90	197,40	104,90	130,00	-	260,35	-	42,20	76,20	12,70	7,10	84,80	43,20
	inch	7,83	7,77	4,13	5,12	-	10,25	-	1,66	3,00	0,50	0,28	3,34	1,70
SS-BVNF12-8S-10K	mm	198,90	197,40	104,90	130,00	-	260,35	-	42,20	76,20	12,70	7,10	84,80	43,20
	inch	7,83	7,77	4,13	5,12	-	10,25	-	1,66	3,00	0,50	0,28	3,34	1,70
SS-BVNF16-8S-10K	mm	198,90	197,40	104,90	130,00	-	260,35	-	42,20	76,20	12,70	7,10	84,80	43,20
	inch	7,83	7,77	4,13	5,12	-	10,25	-	1,66	3,00	0,50	0,28	3,34	1,70

3-Way-90° Diverting-Ball Valve

High-Pressure

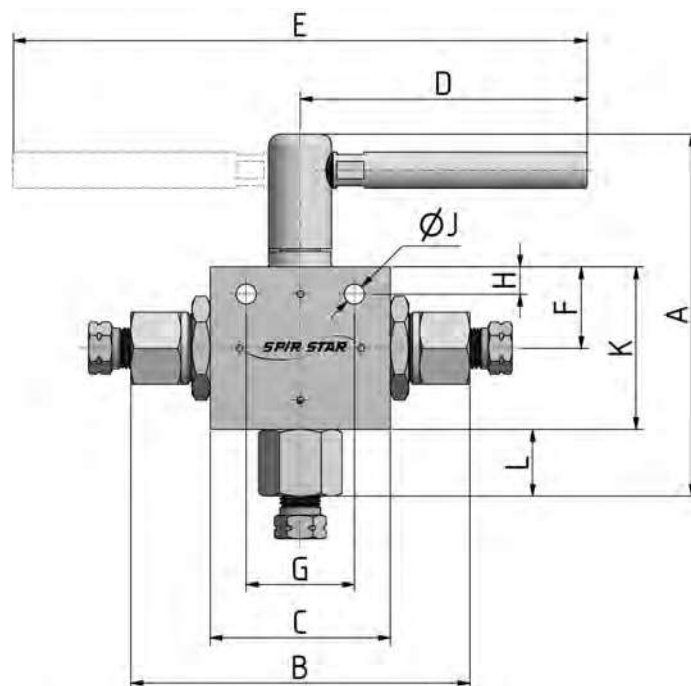

Part Number	Thread Description	Tube Thread	Screw-in Thread	Orifice		Repair Kit	Suitable Tubing
				mm	inch		
Working pressure 1.380 bar / 20.000 psi							
SS-BVHF4-3D-20K	HF4	1/4"x28UNF LH	9/16"x18UNF	4,780	0,188		TU-HP4-60K
SS-BVHF6-3D-20K	HF6	3/8"x24UNF LH	3/4"-16UNF	4,780	0,188		TU-HP6-60K
SS-BVHF9-3D-20K	HF9	9/16"x18UNF LH	1-1/8"x12UNF	4,780	0,188		TU-HP9-60K

Part Number	Unit	Dimensions												
		A	B	C	D1	D2	E	F	G	H	I	J	K	L
SS-BVHF4-3D-20K	mm	146,80	147,30	76,20	102,10	-	-	35,10	50,80	10,40	-	7,10	73,20	26,90
	inch	5,78	5,80	3,00	4,02	-	-	1,38	2,00	0,41	-	0,28	2,88	1,06
SS-BVHF6-3D-20K	mm	146,80	147,30	76,20	102,10	-	-	35,10	50,80	10,40	-	7,10	73,20	26,90
	inch	5,78	5,80	3,00	4,02	-	-	1,38	2,00	0,41	-	0,28	2,88	1,06
SS-BVHF9-3D-20K	mm	146,80	147,30	76,20	102,10	-	-	35,10	50,80	10,40	-	7,10	73,20	26,90
	inch	5,78	5,80	3,00	4,02	-	-	1,38	2,00	0,41	-	0,28	2,88	1,06

3-Way-90° Diverting-Ball Valve

Medium-Pressure

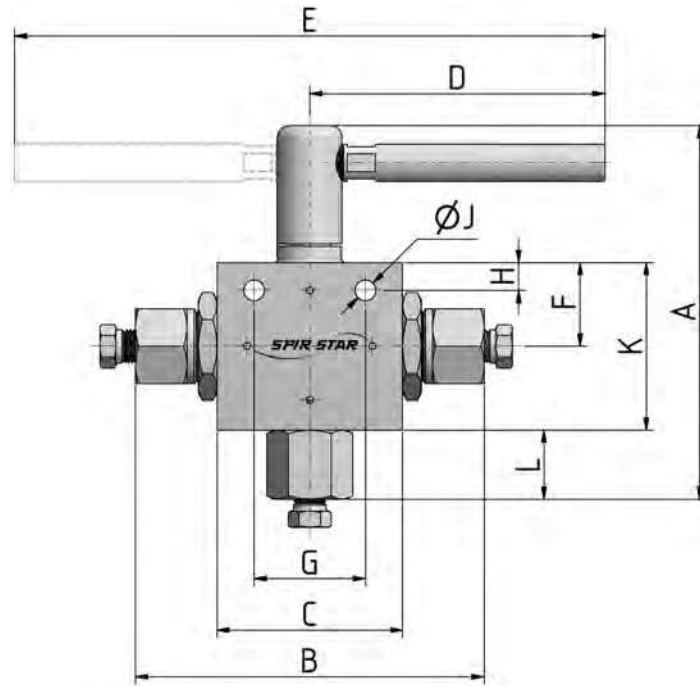

Part Number	Thread	Tube Thread	Screw-in Thread	Orifice		Repair Kit	Suitable Tubing
	Description			mm	inch		
Working pressure 690 bar / 10.000 psi							
SS-BVMF12-8D-10K	MF12	3/4"x16UNF LH	3/4"x14NPSM	12,700	0,500		TU-MPI2-20K
SS-BVMF16-8D-10K	MF16	1"x14UNF LH	1-3/8"x12UNF	12,700	0,500		TU-MPI6-20K
Working pressure 1.035 bar / 15.000 psi							
SS-BVMF6-6D-15K	MF6	3/8"x24UNF LH	9/16"x18UNF	9,530	0,375		TU-MP6-20K
SS-BVMF9-6D-15K	MF9	9/16"x18UNF LH	13/16"-16UNF	9,530	0,375		TU-MP9-20K
SS-BVMF12-6D-15K	MF12	3/4"x16UNF LH	3/4"x14NPSM	9,530	0,375		TU-MPI2-20K
Working pressure 1.380 bar / 20.000 psi							
SS-BVMF4-3D-20K	MF4	1/4"x28UNF LH	7/16"-20UNF	4,780	0,188		TU-MP4-20K
SS-BVMF6-3D-20K	MF6	3/8"x24UNF LH	9/16"x18UNF	4,780	0,188		TU-MP6-20K
SS-BVMF9-3D-20K	MF9	9/16"x18UNF LH	13/16"-16UNF	4,780	0,188		TU-MP9-20K

Part Number	Unit	Dimensions												
		A	B	C	D1	D2	E	F	G	H	I	J	K	L
SS-BVMF4-3D-20K	mm	146,80	147,30	76,20	102,10	-	-	35,10	50,80	10,40	-	7,10	73,20	26,90
	inch	5,78	5,80	3,00	4,02	-	-	1,38	2,00	0,41	-	0,28	2,88	1,06
SS-BVMF6-3D-20K	mm	146,80	147,30	76,20	102,10	-	-	35,10	50,80	10,40	-	7,10	73,20	26,90
	inch	5,78	5,80	3,00	4,02	-	-	1,38	2,00	0,41	-	0,28	2,88	1,06
SS-BVMF6-6D-15K	mm	146,80	147,30	76,20	102,10	-	-	35,10	50,80	10,40	7,10	-	73,20	26,90
	inch	5,78	5,80	3,00	4,02	-	-	1,38	2,00	0,41	0,28	-	2,88	1,06
SS-BVMF9-3D-20K	mm	146,80	147,30	76,20	102,10	-	-	35,10	50,80	10,40	-	7,10	73,20	26,90
	inch	5,78	5,80	3,00	4,02	-	-	1,38	2,00	0,41	-	0,28	2,88	1,06
SS-BVMF9-6D-15K	mm	146,80	147,30	76,20	102,10	-	-	35,10	50,80	10,40	7,10	-	73,20	26,90
	inch	5,78	5,80	3,00	4,02	-	-	1,38	2,00	0,41	0,28	-	2,88	1,06
SS-BVMF12-6D-15K	mm	146,80	147,30	76,20	102,10	-	-	35,10	50,80	10,40	7,10	-	73,20	26,90
	inch	5,78	5,80	3,00	4,02	-	-	1,38	2,00	0,41	0,28	-	2,88	1,06
SS-BVMF12-8D-10K	mm	198,90	197,40	104,90	130,00	-	260,35	-	42,20	76,20	12,70	7,10	84,80	43,20
	inch	7,83	7,77	4,13	5,12	-	10,25	-	1,66	3,00	0,50	0,28	3,34	1,70
SS-BVMF16-8D-10K	mm	198,90	197,40	104,90	130,00	-	260,35	-	42,20	76,20	12,70	7,10	84,80	43,20
	inch	7,83	7,77	4,13	5,12	-	10,25	-	1,66	3,00	0,50	0,28	3,34	1,70

3-Way-90° Diverting-Ball Valve



NPT

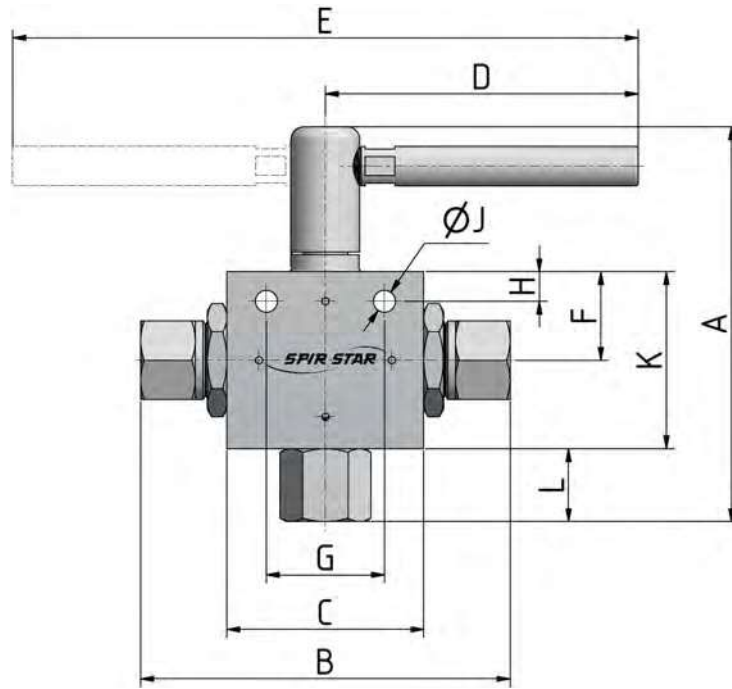

Part Number	Thread Description	Tube Thread	Screw-in Thread	Orifice		Repair Kit	Suitable Tubing
				mm	inch		
Working pressure 690 bar / 10.000 psi							
SS-BVNF8-8D-10K	NF8		1/2"	12,700	0,500		
SS-BVNF12-8D-10K	NF12		3/4"	12,700	0,500		
SS-BVNF16-8D-10K	NF16		1"	12,700	0,500		
Working pressure 1.035 bar / 15.000 psi							
SS-BVNF4-3D-15K	NF4		1/4"	4,780	0,188		
SS-BVNF4-6D-15K	NF4		1/4"	9,530	0,375		
SS-BVNF6-3D-15K	NF6		3/8"	4,780	0,188		
SS-BVNF6-6D-15K	NF6		3/8"	9,530	0,375		
SS-BVNF8-3D-15K	NF8		1/2"	4,780	0,188		
SS-BVNF8-6D-15K	NF8		1/2"	9,530	0,375		

Part Number	Unit	Dimensions												
		A	B	C	D1	D2	E	F	G	H	I	J	K	L
SS-BVNF4-3D-15K	mm	146,80	147,30	76,20	102,10	-	-	35,10	50,80	10,40	-	7,10	73,20	26,90
	inch	5,78	5,80	3,00	4,02	-	-	1,38	2,00	0,41	-	0,28	2,88	1,06
SS-BVNF4-6D-15K	mm	146,80	147,30	76,20	102,10	-	-	35,10	50,80	10,40	7,10	-	73,20	26,90
	inch	5,78	5,80	3,00	4,02	-	-	1,38	2,00	0,41	0,28	-	2,88	1,06
SS-BVNF6-3D-15K	mm	146,80	147,30	76,20	102,10	-	-	35,10	50,80	10,40	-	7,10	73,20	26,90
	inch	5,78	5,80	3,00	4,02	-	-	1,38	2,00	0,41	-	0,28	2,88	1,06
SS-BVNF6-6D-15K	mm	146,80	147,30	76,20	102,10	-	-	35,10	50,80	10,40	7,10	-	73,20	26,90
	inch	5,78	5,80	3,00	4,02	-	-	1,38	2,00	0,41	0,28	-	2,88	1,06
SS-BVNF8-3D-15K	mm	146,80	147,30	76,20	102,10	-	-	35,10	50,80	10,40	-	7,10	73,20	26,90
	inch	5,78	5,80	3,00	4,02	-	-	1,38	2,00	0,41	-	0,28	2,88	1,06
SS-BVNF8-6D-15K	mm	146,80	147,30	76,20	102,10	-	-	35,10	50,80	10,40	7,10	-	73,20	26,90
	inch	5,78	5,80	3,00	4,02	-	-	1,38	2,00	0,41	0,28	-	2,88	1,06
SS-BVNF8-8D-10K	mm	198,90	197,40	104,90	130,00	-	260,35	-	42,20	76,20	12,70	7,10	84,80	43,20
	inch	7,83	7,77	4,13	5,12	-	10,25	-	1,66	3,00	0,50	0,28	3,34	1,70
SS-BVNF12-8D-10K	mm	198,90	197,40	104,90	130,00	-	260,35	-	42,20	76,20	12,70	7,10	84,80	43,20
	inch	7,83	7,77	4,13	5,12	-	10,25	-	1,66	3,00	0,50	0,28	3,34	1,70
SS-BVNF16-8D-10K	mm	198,90	197,40	104,90	130,00	-	260,35	-	42,20	76,20	12,70	7,10	84,80	43,20
	inch	7,83	7,77	4,13	5,12	-	10,25	-	1,66	3,00	0,50	0,28	3,34	1,70